



# WHEEL-A-THON

*Please read through carefully and mark your calendars*

## *Important Dates*

**9/11** \$5 participation form & permission slips due

**9/27** WAT Day

**10/18** Final due date for pledges

**10/31** Award Assembly

## *Pledge Website*

**Be on the look out for an email from Pledge Star!!**

**Jessica Lucia**

p. 925.949.6744

e. SAwheelathon@gmail.com



## What is Wheel-A-Thon

Wheel-A-Thon is one of St. Agnes School's greatest fundraising efforts of the year! It is the **ONLY** event that raises money to finance educational field trips. Examples of previous field trips include: Caritas Creek Camp (5th) Monte Toyon (3rd), NASA facilities, Fort Ross, California Missions, Marine Mammal Center of Marin, The State Capital, Walnut Creek Performing Arts Center, and various cultural events.

## How to contribute

Students are encouraged to seek contributions for them riding during the Wheel-A-Thon. Contributors promise to make a tax-deductible donation which they can donate using the Pledge Star link that will be emailed to you. Be sure to check with your workplace since many offer matching contributions!



# 2024 WAT PRIZES

## Top donation brought in by a student per class

- PK & Kinder
  - Ball Toss Ladder
- First & Second
  - Axe Throwing
- Third & Fourth
  - Scooter
- Fifth
  - Soccer Dart
- Sixth & Seventh
  - Kan Jam
- Eighth
- Spike Ball

## Paddle Board

\*any student who brings in over \$200 in donations will be placed in a raffle, ticket will be drawn at Award assembly

## Top Class Participation

- Class Trophy
- Pizza and Ice Cream party
  - Class with the most participation (riders and students who receive donations, donation amount does not count)

## 1st Place Class with highest donation amount

- Ice Cream Party and Free Dress Pass

## 2nd Place Class with highest donation amount

- Ice Cream Party

## 3rd Place Class with highest donation amount

- Ice Cream Party

## RIDER TIMES

# IMPORTANT NOTES

- Participation fee of \$5 per rider
- Rider name must be placed on bike, so it can be clearly seen before they are brought to school. (Use tape or a label to write name on bike & helmet)
- During drop off, parents & kids stay in car while volunteers unload bikes
- During pick up, bikes will be loaded into vehicles and then cars will move into regular carline
- Every rider must wear a helmet!
- There are two tracks available to those children in Kinder through 2nd grade, a T-Track for those who ride bikes with training wheels, and a Small track for those on two wheels. No "Big Wheels", striders or scooters allowed.
- 3rd - 8th grade will have one track available to those who ride. Only two wheel bikes allowed (no striders)
- As a safety precaution for all students, please make sure your child is proficient at riding the bike they bring to participating
- All children must have a parent or guardian's signature on the permission form to ride
- We can NOT allow anyone without a signature to ride, due to liability concerns.
- Pre-School children will walk the track and not ride, pick up and drop off will be at the flagpole

**PK** 9:55

**K** 8:20

**1** 8:45

**2** 9:20

**3** 8:30

**4** 8:30

**5** 9:20

**6** 9:20

**7** 10:10

**8** 10:10



# Wheel-A-Thon Drop-Off / Pick-Up Routes

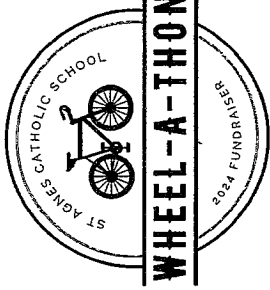

Morning Drop-Off: Follow the path of the  arrow lines - volunteers will guide you.

Afternoon Pick-Up: Follow the path of the  arrow lines - volunteers will guide you.

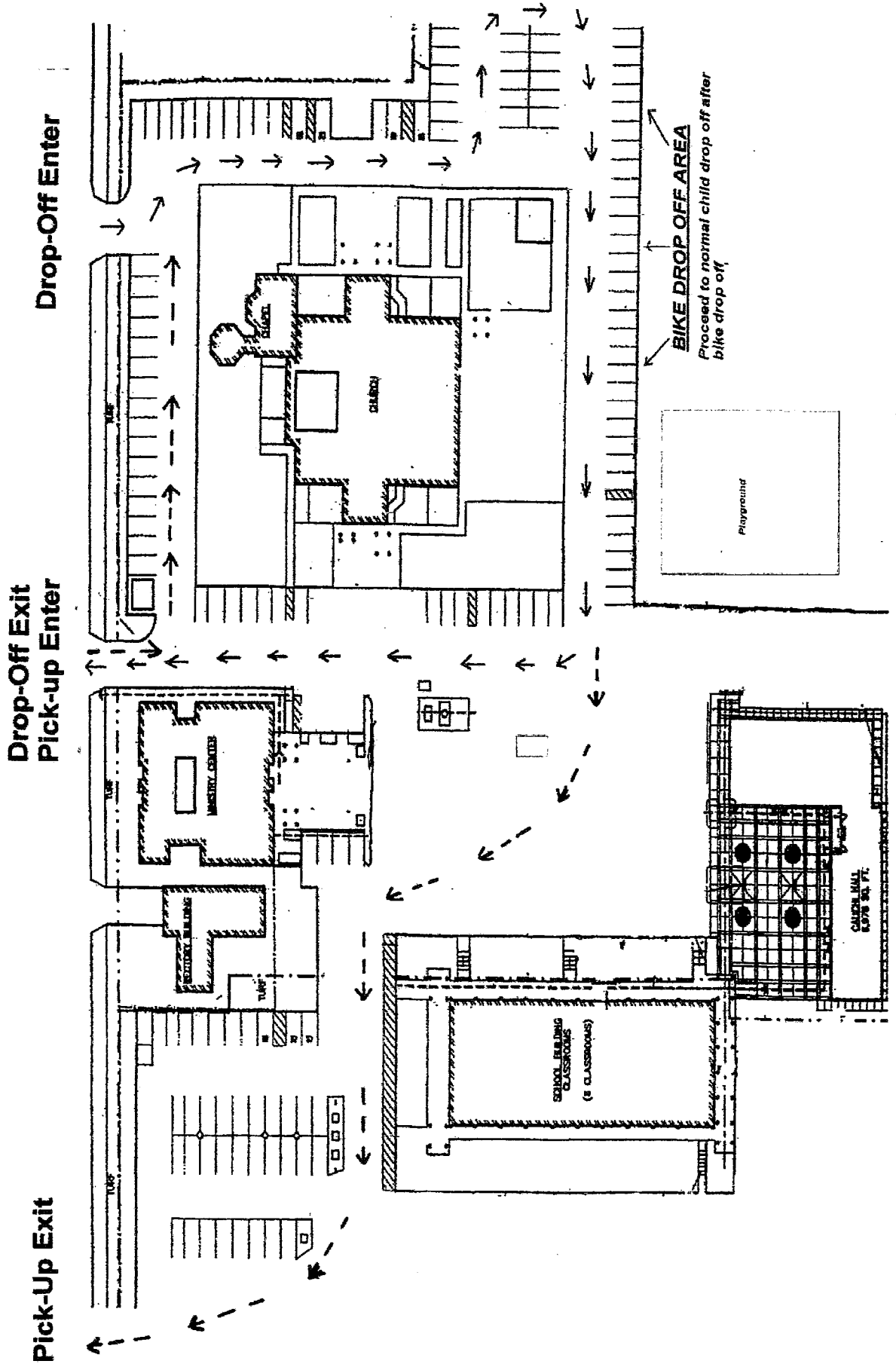



# ST AGNES CATHOLIC SCHOOL

## WHEEL-A-THON RIDER TIMES

*START TIMES*

*ENDING TIMES*

---

<b>PK</b>	<b>9:55</b>	<b>PK</b>	<b>10:00</b>
<b>K</b>	<b>8:20</b>	<b>K</b>	<b>8:40</b>
<b>1</b>	<b>8:45</b>	<b>1</b>	<b>9:15</b>
<b>2</b>	<b>9:20</b>	<b>2</b>	<b>9:50</b>
<b>3</b>	<b>8:30</b>	<b>3</b>	<b>9:15</b>
<b>4</b>	<b>8:30</b>	<b>4</b>	<b>9:15</b>
<b>5</b>	<b>9:20</b>	<b>5</b>	<b>10:05</b>
<b>6</b>	<b>9:20</b>	<b>6</b>	<b>10:05</b>
<b>7</b>	<b>10:10</b>	<b>7</b>	<b>11:00</b>
<b>8</b>	<b>10:10</b>	<b>8</b>	<b>11:00</b>



**DUE  
9/11**

# ST AGNES CATHOLIC SCHOOL

## WHEEL-A-THON PARENT PERMISSION FORM

**KINDLY FILL IN THE SPACES PROVIDED AFTER READING THE STATEMENT.**

I hereby request that my son/daughter,

\_\_\_\_\_

NAME

\_\_\_\_\_

GRADE

be able to participate in the St. Agnes School Wheel-A-Thon, to be held on September 27, 2024.

- I agree to direct my child to cooperate and conform to directions and instructions of the supervisory personnel in charge of this event.
- I understand that any expenses incurred for medical treatment of my child will be first submitted to my personal medical/dental insurance plans. Unpaid benefits can be submitted to Myers-Stevens as a secondary provider.

### CONSENT FOR TREATMENT

(I), the undersigned parent or legal guardian of a minor, do hereby authorize a representative of St. Agnes School as agent(s) for the undersigned to consent to any x-ray examination, anesthetic, medical or surgical diagnosis or treatment and hospital care that is deemed advisable by, and is to be rendered under the general or special supervision of any physician or surgeon licensed under the provision of the California Medical Practice Act, on the medical staff or an accredited hospital, whether such diagnosis or treatment is rendered at the office of said physician or at said hospital.

It is understood that this authorization is given in advance of any specific diagnosis, treatment or hospital care being required but is given to provide authority and power on the part of the above mentioned agent(s) to give specific consent to any and all such diagnosis, treatment or hospital care that the above mentioned physician in the exercise of his or her best judgment may deem advisable.

Signature over Printed Name: \_\_\_\_\_

Date Signed (mm/dd/yy): \_\_\_\_\_

MY CHILD WILL NOT BE PARTICIPATING IN THE 2023 WHEEL-A-THON ON 9/29/2023

Signature over Printed Name: \_\_\_\_\_

Date Signed (mm/dd/yy): \_\_\_\_\_